



Island

Sotheby's
INTERNATIONAL REALTY



Informational content brought to you by

TITLE GUARANTY

A Legacy Built on Promises Delivered

Understanding Tax Map Lines

A guide to reading Hawaii's tax map lines

Ever wonder what those lines on Hawaii's Tax Maps mean? Title Guaranty would like to take the mystery out of this everyday document. Below is a legend explaining the meaning behind the lines! Use this handy information to navigate your way to a successful transaction.

District Boundary Lines (not shown)

Forest Reserve Boundary Lines

Land Title Boundary Lines
(Awards, Grants, etc.)

Easement or Lot Lines

Ownership Boundary Lines

Lines Between Points on Meandering
Boundaries, Radii of Curves and Chords of Arcs

Track Boundary Lines (not shown)

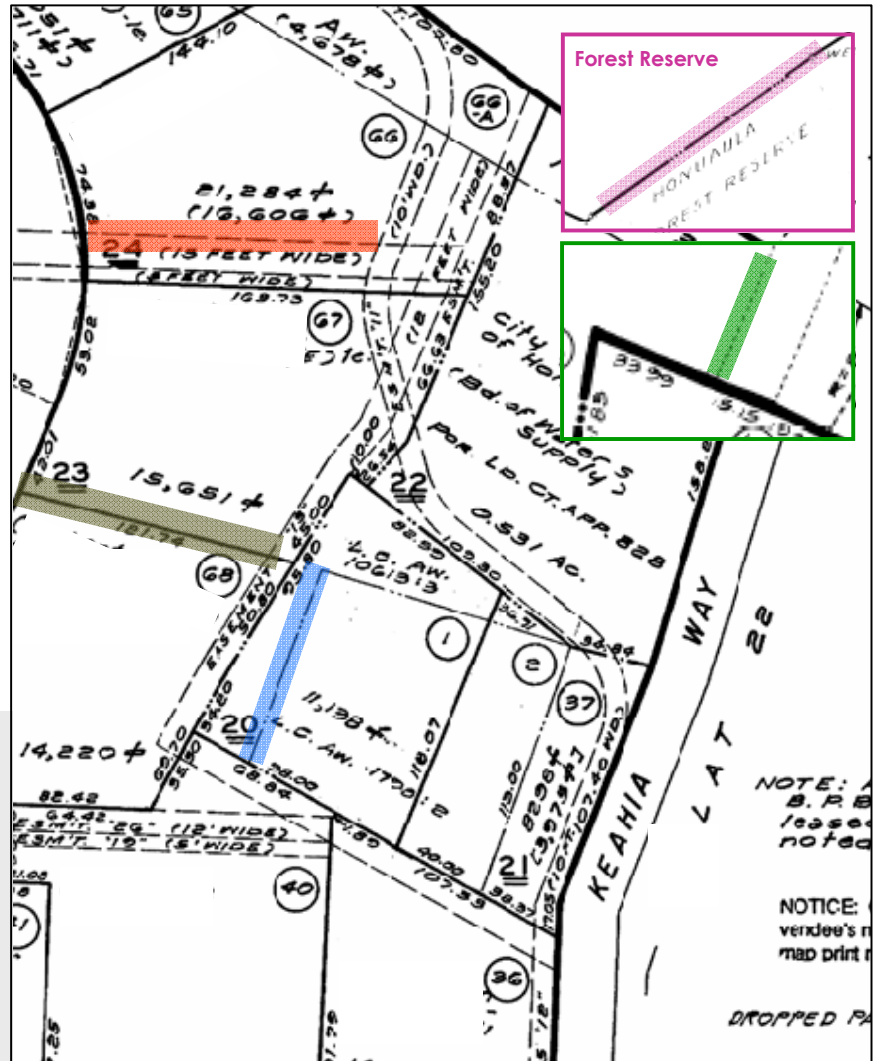

Widths of lines used in conjunction with above to designate:

- Exterior boundary lines of district, zone, section and plat maps 5 pt.
- Street lines within exterior boundary lines and plat maps 4 pt.
- Parcel lines within the plat map 2 pt.
- Easements, sub-lots within parcels 0 pt.
- Radii, chords, ties, consolidated title within parcel 00 pt.

This flyer does not provide tax or legal advice pertaining to a specific situation. Consult a lawyer or tax professional before entering into a transaction. All rights to these materials are reserved; no reproduction without prior written consent.

December 2010

A complete list of FYI flyers is available on TGExpress. Go to:

www.tghawaii.com